

Alloy Steel; Wireless Tension Link; Patent Design

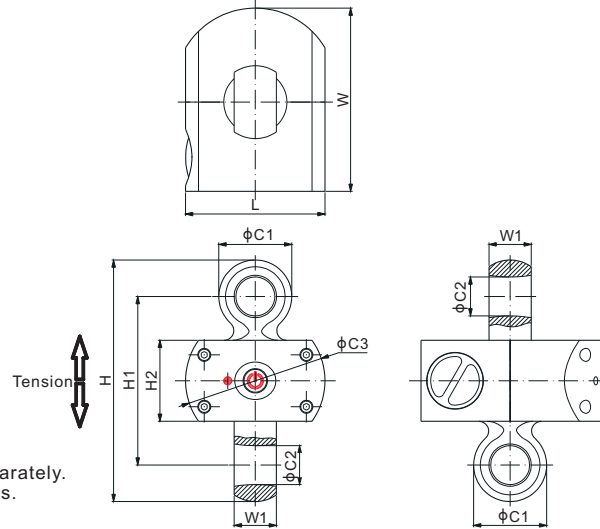

TENSLINK™



* Indicator to be ordered separately. Refer to Page 189 for details.

CE RoHS

TENSION LINKS

RATED CAPACITY	DIMENSIONS									SUGGESTED SHACKLE
	C1	C2	C3	H	H1	H2	L	W	W1	
t/mm										
0.5; 1; 2	33.0	18.0	80.0	110.0	74.0	38.0	80.0	110.0	18.0	Crosby G-2130-2t or SBX-2t
3	35.0	21.0	80.0	129.0	88.0	38.0	80.0	110.0	25.0	Crosby G-2130-3.25t or SBX-3.25t
5	50.0	27.0	86.0	164.6	110.6	50.0	86.0	113.0	33.0	Crosby G-2130-6.5t or SBX-6.5t
10	63.0	37.0	86.0	205.0	135.0	50.0	86.0	125.0	41.0	Crosby G-2130-12t or SBX-12t
20	90.0	53.0	100.0	249.0	153.0	53.0	100.0	140.0	66.0	Crosby G-2130-25t or SBX-25t
30	87.0	44.0	100.0	248.0	150.0	50.0	100.0	152.0	58.0	Crosby G-2140-30t or TBX-30t
50	115.0	62.0	150.0	321.0	206.0	74.0	150.0	170.0	79.0	Crosby G-2140-55t or TBX-50t
100	170.0	88.0	180.0	442.0	260.0	65.0	180.0	190.0	122.0	Crosby G-2140-120t or TBX-110t
Klb/inches (conversion of above dimensions)										
1; 2; 4	1.30	0.71	3.15	4.33	2.91	1.50	3.15	4.33	0.71	Crosby G-2130-2t or SBX-2t
5	1.38	0.83	3.15	5.08	3.46	1.50	3.15	4.33	0.98	Crosby G-2130-3.25t or SBX-3.25t
10	1.97	1.06	3.39	6.48	4.35	1.97	3.39	4.45	1.30	Crosby G-2130-6.5t or SBX-6.5t
20	2.48	1.46	3.39	8.07	5.31	1.97	3.39	4.92	1.61	Crosby G-2130-12t or SBX-12t
40	3.54	2.09	3.94	9.80	6.02	2.09	3.94	5.51	2.60	Crosby G-2130-25t or SBX-25t
60	3.43	1.73	3.94	9.76	5.91	1.97	3.94	5.98	2.28	Crosby G-2140-30t or TBX-30t
100	4.53	2.44	5.91	13.03	8.11	2.91	5.91	6.69	3.11	Crosby G-2140-55t or TBX-50t
200	6.69	3.46	7.09	17.40	10.24	2.56	7.09	7.48	4.80	Crosby G-2140-120t or TBX-110t

SPECIFICATIONS					
Division	500kg	0.1kg	Combined Error	0.03%	
	1t	0.2kg	Max. Safety Load	200% of full scale	
	2t	0.5kg	Ultimate Load	500% of full scale	
	3t, 5t	1kg	Transmission Range	Up to 30m at lowest power setting.	
	10t	2kg		Up to 75m at highest power setting, unobstructed	
	20t	5kg	Rechargeable Battery Type	3 × AA Alkaline batteries	
	30t, 50t	10kg	Operation Time	Up to 100 hours at 20°C and at the lowest power setting	
	100t	20kg	Operating Humidity	<85% RH under 20°C [68°F]	
	IP Rating	IP67		Operating Temperature	-10°C to 50°C / 14°F to 122°F
	Enclosure	Alloy Steel, Powder Coating			

PART NUMBER			
Rated Capacity	Frequency	Part No.	Self Weight Approx. (kg)
500kg.....	433 MHz.....	110RH-ST-500kg-WL01.....	0.6
	915 MHz.....	110RH-ST-500kg-WL02.....	0.6
1t	433 MHz.....	110RH-ST-1t-WL01.....	0.6
	915 MHz.....	110RH-ST-1t-WL02.....	0.6
2t	433 MHz.....	110RH-ST-2t-WL01.....	0.6
	915 MHz.....	110RH-ST-2t-WL02.....	0.6
3t	433 MHz.....	110RH-ST-3t-WL01.....	1.0
	915 MHz.....	110RH-ST-3t-WL02.....	1.0
5t	433 MHz.....	110RH-ST-5t-WL01.....	1.4
	915 MHz.....	110RH-ST-5t-WL02.....	1.4

PART NUMBER			
Rated Capacity	Frequency	Part No.	Self Weight Approx. (kg)
10t	433 MHz.....	110RH-ST-10t-WL01.....	2.3
	915 MHz.....	110RH-ST-10t-WL02.....	2.3
20t	433 MHz.....	110RH-ST-20t-WL01.....	4.7
	915 MHz.....	110RH-ST-20t-WL02.....	4.7
30t	433 MHz.....	110RH-30t-WL01.....	5.5
	915 MHz.....	110RH-30t-WL02.....	5.5
50t	433 MHz.....	110RH-50t-WL01.....	16.0
	915 MHz.....	110RH-50t-WL02.....	16.0
100t	433 MHz.....	110RH-100t-WL01.....	35.0
	915 MHz.....	110RH-100t-WL02.....	35.0

All product specifications, statements, information and data (collectively, the "Information") in this catalog or made available elsewhere by ANYLOAD are subject to change. The customer is responsible for checking and verifying the extent to which the Information contained in this publication is applicable to an order at the time the order is placed. All Information given herein is believed to be accurate and reliable, but it is presented without guarantee, warranty, or responsibility of any kind, expressed or implied.

Data listed in the datasheet is produced within controlled laboratory settings and may not be reproducible without exact replication of all conditions. It is the customer's responsibility to validate that a particular product with the properties described in the product specifications is suitable for use in their applications. Statements of interchangeability with other manufacturers are based on ANYLOAD's knowledge of product information at the time a publication was made, but are not intended to constitute any warranty concerning the substitutability of an ANYLOAD product with one made by another manufacturer.

Any use of product outside of specifications or any storage or installation inconsistent with product guidance voids and warranty.

The information is intended for use only by customers who have the requisite experience and capability to determine the correct products for their application. Any technical advice inferred from this Information or otherwise provided by ANYLOAD with reference to the use of ANYLOAD's products produces no obligation or liability for the advice given or results obtained.

Although ANYLOAD designs and manufactures its products to the most stringent quality and safety standards, isolated component failures may still occur. Accordingly, customer applications which require a high degree of reliability or safety should employ suitable designs or other safeguards in order to ensure that the failure of an electrical component does not result in a risk of personal injury or property damage.

Unless specifically agreed to in writing, ANYLOAD has not tested or certified its products, services or deliverables for use in high risk applications including medical life support, medical device, direct physical patient contact, water treatment, nuclear facilities, weapon systems, mass and air transportation control, flammable environments, or any other potentially life critical uses. Customer understands and agrees that ANYLOAD makes no assurances that the products, services or deliverables are suitable for any high-risk uses. Under no circumstances does ANYLOAD warrant or guarantee suitability for any customer design or manufacturing process. Although all product - related warnings, cautions and notes must be observed, the customer should not assume that all safety measures are indicated or that other measures may not be required. Please contact authorized ANYLOAD personnel to obtain special terms and conditions regarding products designed for such applications or otherwise satisfy specific safety requirements.