

247ASLH;247ASLHUN

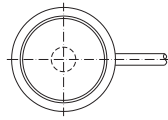

Stainless Steel



Capacity: 250-10,000kg

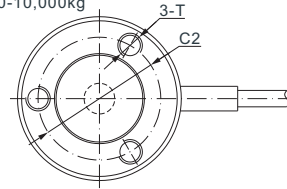

CE RoHS

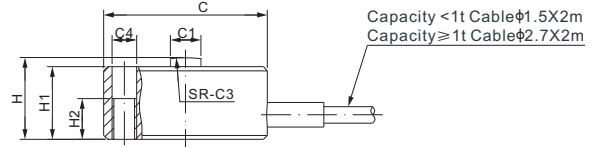
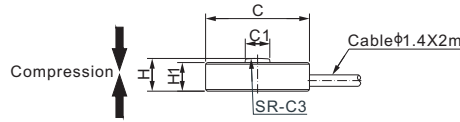

DIMENSIONS

| RATED CAPACITY | C | C1 | C2 | C3 | C4 | H | H1 | H2 | T |
|-------------------|------|------|------|------|-----|------|------|-----|--------------|
| 247ASLH: | | | | | | | | | |
| kg/mm | | | | | | | | | |
| 10 | 9.7 | 2.3 | - | 12.7 | - | 3.6 | 3.2 | - | - |
| 25-100 | 12.7 | 3.0 | - | 19.1 | - | 4.5 | 4.0 | - | - |
| 250-500 | 20.0 | 3.8 | 15.0 | 15.0 | 3.0 | 10.0 | 8.9 | 5.0 | M3 |
| 1,000-2,000 | 37.6 | 10.9 | 31.8 | 76.2 | 3.5 | 16.0 | 14.0 | 6.4 | M3 |
| 5,000-10,000 | 50.3 | 15.2 | 41.4 | 200 | - | 25.4 | 22.4 | - | M4 |
| 247ASLHUN: | | | | | | | | | |
| kg/mm | | | | | | | | | |
| 250-500 | 20.0 | 3.8 | 15.0 | 15.0 | 3.0 | 10.0 | 8.9 | 5.0 | #6-32 UNC-2B |
| 1,000-2,000 | 37.6 | 10.9 | 31.8 | 76.2 | 3.5 | 16.0 | 14.0 | 6.4 | #6-32 UNC-2B |
| 5,000-10,000 | 50.3 | 15.2 | 41.4 | 200 | - | 25.4 | 22.4 | - | #6-32 UNC-2B |

SPECIFICATIONS

| | | | |
|--------------------------|--|----------------------------------|---|
| Full Scale Output | Cap. ≤10kg: ≥0.8 mV/V; Cap. >10kg: 2.0 mV/V ± 20% | Recommended Excitation | Cap. ≤10kg: 5V (7V Maximum) Cap. >10kg: 10V (15V Maximum) |
| Zero Balance | Cap. ≤10kg: ±0.03 mV/V Cap. >10kg: ±0.04 mV/V | Insulation Resistance | >2 [50V DC] GΩ |
| Non-linearity | < ±0.5% | Nominal Temperature Range | -10°C to 40°C / 14°F to 104°F |
| Repeatability | < ±0.5% | Safe Overload | 150% of full scale |
| Hysteresis Error | < ±0.5% | Breaking Overload | 300% of full scale |
| Creep in 30 min. | < ±0.5% | Seal Type / IP Rating | Environmentally Sealed / IP66 |
| Input Resistance | Cap. ≤500kg: 375 Ω ± 25; Cap. >500kg: 700 Ω ± 25 | Cable Color Code | Cap. ≤500kg: Exc+ Red Exc- Black Sig+ Green Sig- Yellow Shield Bare Cap. >500kg: Exc+ Red Exc- Black Sig+ Green Sig- White Shield Bare |
| Output Resistance | Cap. ≤500kg: 350 Ω ± 3; Cap. >500kg: 700 Ω ± 3 | | |
| Element Material | 17-4PH Stainless Steel | | |

PART NUMBER

| Rated Capacity | Part No. | Weight (kg) Approx. |
|-----------------------------------|--------------------|---------------------|
| 10-100kg, No thread | | |
| 10kg..... | 247ASLH-10kg..... | 0.09 |
| 25kg..... | 247ASLH-25kg..... | 0.09 |
| 50kg..... | 247ASLH-50kg..... | 0.09 |
| 100kg..... | 247ASLH-100kg..... | 0.09 |
| 250kg to 2t, Metric thread | | |
| 250kg..... | 247ASLH-250kg..... | 0.11 |
| 500kg..... | 247ASLH-500kg..... | 0.11 |
| 1t..... | 247ASLH-1t..... | 0.19 |
| 2t..... | 247ASLH-2t..... | 0.19 |
| 5t..... | 247ASLH-5t..... | 0.42 |
| 10t..... | 247ASLH-10t..... | 0.42 |

PART NUMBER

| Rated Capacity | Part No. | Weight (kg) Approx. |
|-------------------------------------|----------------------|---------------------|
| 250kg to 2t, Imperial thread | | |
| 250kg..... | 247ASLHUN-250kg..... | 0.11 |
| 500kg..... | 247ASLHUN-500kg..... | 0.11 |
| 1t..... | 247ASLHUN-1t..... | 0.19 |
| 2t..... | 247ASLHUN-2t..... | 0.19 |
| 5t..... | 247ASLHUN-5t..... | 0.42 |
| 10t..... | 247ASLHUN-10t..... | 0.42 |

APPLICATION EXAMPLES

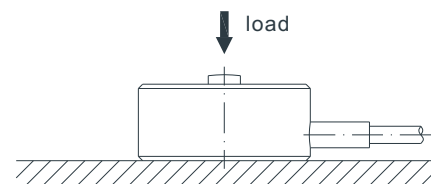

LOAD BUTTONS