

## LED Industrial Weight Indicator

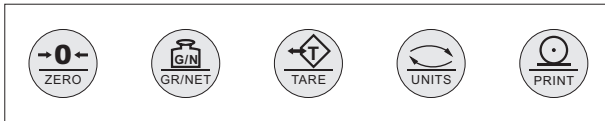

### Keyboard Configuration



### Features:

- 6 digits, 7 segments, 0.8", LED display
- Indication of up to four units of measurements: kg, lb, oz and g
- Indication of gross, net and tare
- Indication of stability and centre of zero
- Easy wiring plug in screw terminals
- Weight, peak and piece counting
- Password protected calibration menu
- Physical and electronic sealing via audit trail function
- Two set point output relays
- Advance analogue, digital and average filtering
- Two independent RS232 serial communication ports
- One independent RS485 serial communication port
- Weather proof stainless steel enclosure, NEMA4X / IP66
- Breather vent to avoid condensation inside

### Specifications

<b>Power Supply</b>	UL approved internal, 100VAC to 240VAC, 50-60Hz Max. Power consumption: 5W
<b>Excitation Voltage</b>	5V DC $\pm$ 5%
<b>Number of load cells</b>	Max.: 8x350 $\Omega$ ; 16x700 $\Omega$
<b>Input Range</b>	Up to 39mV
<b>Sample Rate</b>	12.5ms or 80Hz
<b>Resolution</b>	1,000,000 internal count, with 24bits resolution
<b>Division</b>	1; 2; 5; 10; 20; 50; 100
<b>Tare range</b>	100% Full Scale
<b>Communicate interface</b>	2 x RS-232C, 1 x RS-485
<b>Output</b>	2 x form C Relays
<b>Working Humidity</b>	20% RH to 90% RH
<b>Working Temperature</b>	-10°C to 50°C / 14°F to 122°F
<b>Dimensions (W x H x D)</b>	9.1" x 7.4" x 3.0" (231 x 188 x 76mm) base included

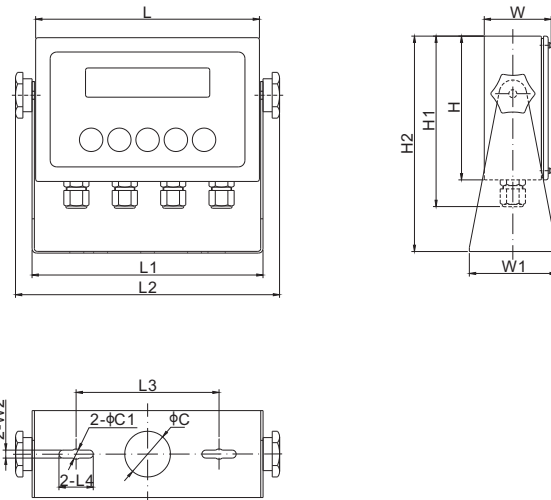

### DIMENSIONS

L	7.4in (188mm)	H	4.6in (118mm)	W	2.3in (58mm)
L1	7.6in (194mm)	H1	5.6in (142mm)	W1	3.0in (76mm)
L2	8.8in (223mm)	H2	6.6in (168mm)	W2	0.3in (7mm)
L3	4.9in (125mm)	C	1.6in (40mm)		
L4	1.2in (30mm)	C1	0.4in (9mm)		

### PART NUMBER

Part No.	Power Supply	Weight (kg) Approx.
815TS-B-21B.....	Internal.....	2.3

INDICATORS & REMOTE DISPLAYS