

563YHM4-02

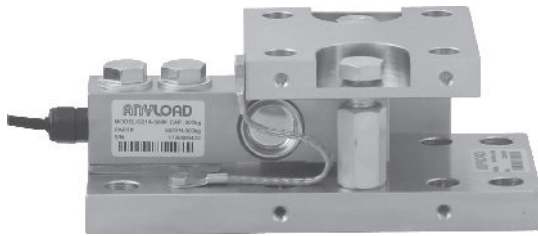

Alloy Steel



Load Cell Certifications:



Load Cell Not Included.

Features:

- Assembles: 563YH alloy steel shear beam load cell
- Capacities: 100lb-20Klb/100kg-10t
- Integral "Jacking" for easy load cell removal/installation
- Rocker pin design-allows for 360° thermal expansion
- Both uplift and overload protection with lateral stops
- Versatile mounting options for conventional tank/vessel leg
 - Able to use existing 4-square tank leg mount holes in floor
 - Free to rotate for fixed position 360° w/same 4-mount holes
 - Able to flip entire mount 180° for further mount options
- Side holes each side for shipping & installation brackets
- Flexible stainless steel braided grounding strap

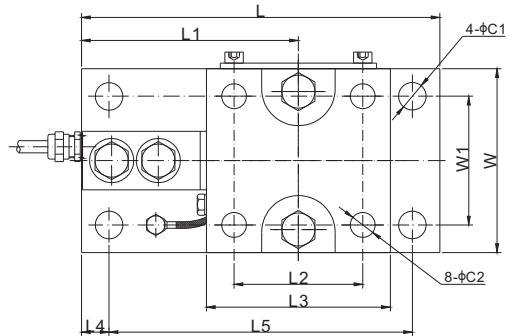
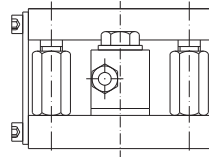
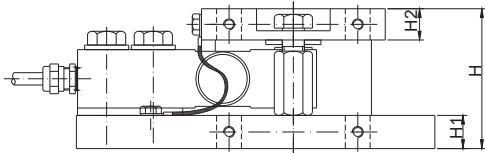

DIMENSIONS

| LOAD CELL CAPACITY | C1 | C2 | H | H1 | H2 | L | L1 | L2 | L3 | L4 | L5 | W | W1 |
|--------------------|------|------|-------|------|------|-------|-------|-------|-------|------|-------|-------|-------|
| lb/inches | | | | | | | | | | | | | |
| 100-4,000;SE5,000 | 0.59 | 0.53 | 2.99 | 0.71 | 0.67 | 7.68 | 4.65 | 2.76 | 3.94 | 0.59 | 6.50 | 3.94 | 2.76 |
| 5,000-10,000 | 0.71 | 0.59 | 4.33 | 1.06 | 0.98 | 9.57 | 6.00 | 3.35 | 4.72 | 0.75 | 8.07 | 4.72 | 3.35 |
| 15,000-20,000 | 0.87 | 0.79 | 5.73 | 1.42 | 1.26 | 12.52 | 7.76 | 4.09 | 5.98 | 1.00 | 10.52 | 5.98 | 4.09 |
| kg/mm | | | | | | | | | | | | | |
| 100-2,000 | 15.0 | 13.5 | 76.0 | 18.0 | 17.0 | 195.0 | 118.0 | 70.0 | 100.0 | 15.0 | 165.1 | 100.0 | 70.0 |
| 3,000-5,000 | 18.0 | 15.0 | 110.0 | 27.0 | 25.0 | 243.0 | 152.5 | 85.0 | 120.0 | 19.0 | 205.0 | 120.0 | 85.0 |
| 10,000 | 22.0 | 20.0 | 145.5 | 36.0 | 32.0 | 318.0 | 197.0 | 104.0 | 152.0 | 25.4 | 267.2 | 152.0 | 104.0 |

SE refers to small envelope

PART NUMBER

| Load Cell Capacity | Part No. | Weight (kg) Approx. |
|--------------------|------------------------------|---------------------|
| 100lb-SE5Klb..... | 563YHM4-(0.1-SE5)Klb-02..... | 4.2 |
| 5Klb-10Klb..... | 563YHM4-(5-10)Klb-02..... | 9.8 |
| 15Klb-20Klb..... | 563YHM4-(15-20)Klb-02..... | 20.5 |
| 100kg-2t..... | 563YHM4-(100kg-2t)-02..... | 4.2 |
| 3t-5t..... | 563YHM4-(3-5)t-02..... | 9.8 |
| 10t..... | 563YHM4-10t-02..... | 20.5 |