

End Link, Cast Steel

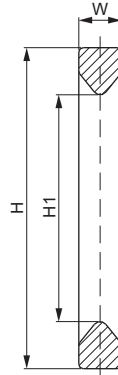
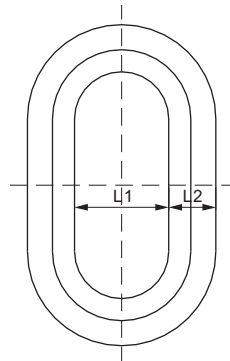
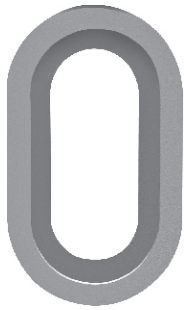

DIMENSIONS

PART NUMBER	H	H1	L1	L2	W	Safe Working Load
inches						
EL-29	8.58	6.06	2.52	1.26	1.14	27,500 lb
mm (conversion of above dimensions)						
EL-29	218.0	154.0	64.0	32.0	29.0	12,474kg