

Wireless Transmission Module



Indicator to be ordered separately.
Refer to Page 151 for details.

Features:

- 3xAA alkaline batteries works up to 100 hours on 20°C at the lowest power set up
- PVC water-proof, IP67
- Wireless Frequency: 433Mhz or 915Mhz
- Transmission Range: Up to 75m without obstruction
- One 7-pin connect included, which can connect the cable with external diameter of 5 - 8mm
- Matched with 805HP-WL wireless indicator (order separately)

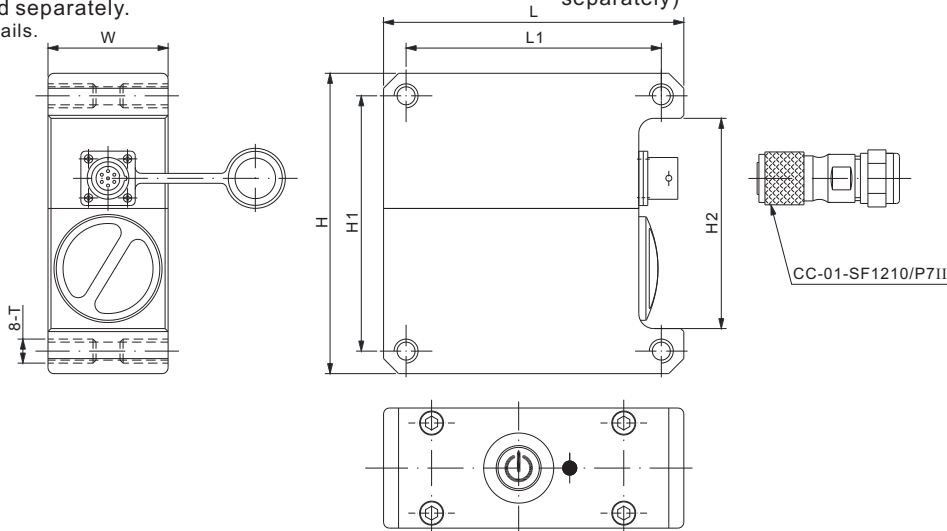

DIMENSIONS

| | H | H1 | H2 | L | L1 | W | T |
|--------|-------|------|------|-------|------|------|--------------|
| mm | 100.0 | 85.0 | 70.0 | 100.0 | 85.0 | 40.0 | M8 Depth15 |
| inches | 3.94 | 3.35 | 2.76 | 3.94 | 3.35 | 1.57 | M8 Depth0.59 |

SPECIFICATIONS

| | | |
|-----------------------|-------|--|
| Load Cell Type | | Any kind of mV/V output load cell, force transducer, sensor or scale |
| Net Weight | kg/lb | 0.7 / 1.5 |
| Transmission Range | m | Up to 30m at lowest power set up and up to 75m at highest power set up (no obstructions) |
| Operation Time | hours | Up to 100 on 20°C at the lowest power set up |
| Working Temperature | °C/°F | -20 to 70 / -4 to 158 |
| Wireless Frequency | Mhz | 433; 915 |
| Power Supply | | 3xAA Alkaline batteries (included) |
| IP Rating | | IP67 |
| Enclosure Material | | PVC |
| Min power consumption | mW | 1.26 |
| Max power consumption | mW | 6.25 |

PART NUMBER

| Part No. | Frequency | Net Weight (kg) |
|-------------------|-------------|-----------------|
| WL01-RFTM-17..... | 433Mhz..... | 0.7 |
| WL02-RFTM-17..... | 915Mhz..... | 0.7 |

CONNECTION DIAGRAM

