

## Stainless Steel

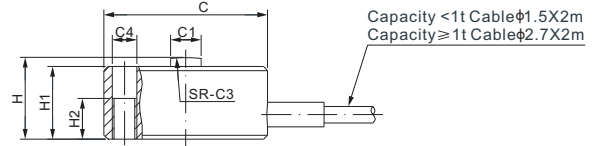

Capacity: 10-100kg

Capacity: 250-10,000kg

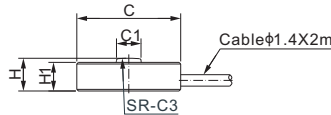
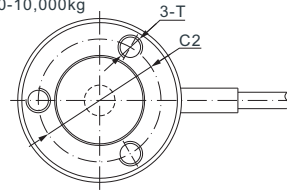
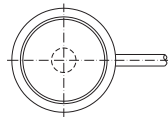

CE RoHS

### DIMENSIONS

RATED CAPACITY	C	C1	C2	C3	C4	H	H1	H2	T
<b>kg/mm</b>									
10	9.7	2.3	-	12.7	-	3.6	3.2	-	-
25-100	12.7	3.0	-	19.1	-	4.5	4.0	-	-
250-500	20.0	3.8	15.0	15.0	3.0	10.0	8.9	5.0	M3
1,000-2,000	37.6	10.9	31.8	76.2	3.5	16.0	14.0	6.4	#6-32 UNC-2B
5,000-10,000	50.3	15.2	41.4	200	-	25.4	22.4	-	#6-32 UNC-2B Depth 6.4
<b>lb/inches</b> (conversion of above dimensions)									
22.05	0.38	0.09	-	0.50	-	0.14	0.13	-	-
55.12-220.46	0.50	0.12	-	0.75	-	0.18	0.16	-	-
551.16-1,102.31	0.79	0.15	0.59	0.59	0.12	0.39	0.35	0.20	M3
2,204.62-4,409.25	1.48	0.43	1.25	3.00	0.14	0.63	0.55	0.25	#6-32 UNC-2B
11,023.11-22,046.23	1.98	0.60	1.63	7.87	-	1.00	0.88	-	#6-32 UNC-2B Depth 0.25

### SPECIFICATIONS

<b>Full Scale Output</b>	Cap. ≤10kg: 1.0 mV/V ± 20%; Cap. >10kg: 2.0 mV/V ± 20%	<b>Recommended Excitation</b>	Cap. ≤10kg: 5V (7V Maximum) Cap. >10kg: 10V (15V Maximum)
<b>Zero Balance</b>	Cap. ≤10kg: ± 0.03 mV/V Cap. >10kg: ± 0.04 mV/V	<b>Insulation Resistance</b>	>2 [ 50V DC ] GΩ
<b>Non-linearity</b>	< ± 0.5%	<b>Nominal Temperature Range</b>	-10°C to 40°C / 14°F to 104°F
<b>Repeatability</b>	< ± 0.5%	<b>Safe Overload</b>	150% of full scale
<b>Hysteresis Error</b>	< ± 0.5%	<b>Breaking Overload</b>	300% of full scale
<b>Creep in 30 min.</b>	< ± 0.5%	<b>Seal Type / IP Rating</b>	Environmentally Sealed / IP66
<b>Input Resistance</b>	Cap. ≤500kg: 375Ω ± 25; Cap. >500kg: 700Ω ± 25	<b>Cable Color Code</b>	Cap. ≤500kg: Exc+ Red Exc- Black Sig+ Green Sig- Yellow Shield Bare Cap. >500kg: Exc+ Red Exc- Black Sig+ Green Sig- White Shield Bare
<b>Output Resistance</b>	Cap. ≤500kg: 350Ω ± 3; Cap. >500kg: 700Ω ± 3		
<b>Element Material</b>	17-4PH Stainless Steel		

### PART NUMBER

Rated Capacity	Part No.	Weight (kg) Approx.
10kg.....	247ASLH-10kg.....	0.09
25kg.....	247ASLH-25kg.....	0.09
30kg.....	247ASLH-30kg.....	0.09
50kg.....	247ASLH-50kg.....	0.09
100kg.....	247ASLH-100kg.....	0.09
250kg.....	247ASLH-250kg.....	0.11
500kg.....	247ASLH-500kg.....	0.11
1t.....	247ASLH-1t.....	0.19
2t.....	247ASLH-2t.....	0.19
5t.....	247ASLH-5t.....	0.42
10t.....	247ASLH-10.....	0.42

### APPLICATION EXAMPLES

