

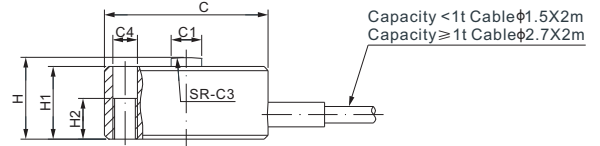

Capacity: 10-100kg

Capacity: 250-2000kg

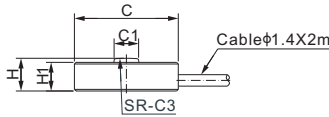
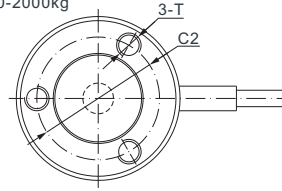
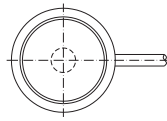

CE RoHS

DIMENSIONS

RATED CAPACITY	C	C1	C2	C3	C4	H	H1	H2	T
kg/mm									
10	9.7	2.3	-	12.7	-	3.6	3.2	-	-
25-100	12.7	3.0	-	19.1	-	4.5	4.0	-	-
250-500	20.0	3.8	15.0	15.0	3.0	10.0	8.9	5.0	M3
1,000-2,000	37.6	10.9	31.8	76.2	3.5	16.0	14.0	6.4	#6-32 UNC-2B
lb/inches (conversion of above dimensions)									
22.05	0.38	0.09	-	0.50	-	0.14	0.13	-	-
55.12-220.46	0.50	0.12	-	0.75	-	0.18	0.16	-	-
551.16-1,102.31	0.79	0.15	0.59	0.59	0.12	0.39	0.35	0.20	M3
2,204.62-4,409.25	1.48	0.43	1.25	3.00	0.14	0.63	0.55	0.25	#6-32 UNC-2B

SPECIFICATIONS			
Full Scale Output	Cap. ≤10kg: 1.0 mV/V ± 20%; Cap. >10kg: 2.0 mV/V ± 20%	Recommended Excitation	Cap. ≤10kg: 5V (7V Maximum) Cap. >10kg: 10V (15V Maximum)
Zero Balance	± 0.02 mV/V	Insulation Resistance	>2 [50V DC] GΩ
Non-linearity	< ± 0.5%	Nominal Temperature Range	-10°C to 40°C / 14°F to 104°F
Repeatability	< ± 0.5%	Safe Overload	150% of full scale
Hysteresis Error	< ± 0.5%	Breaking Overload	300% of full scale
Creep in 30 min.	< ± 0.5%	Seal Type / IP Rating	Environmentally Sealed / IP66
Input Resistance	Cap. ≤500kg: 375 Ω ± 25; Cap. >500kg: 700 Ω ± 25	Cable Color Code	Cap. ≤500kg: Exc+ Red Exc- Black Sig+ Green Sig- Yellow Shield Bare
Output Resistance	Cap. ≤500kg: 350 Ω ± 3; Cap. >500kg: 700 Ω ± 3		Cap. >500kg: Exc+ Red Exc- Black Sig+ Green Sig- White Shield Bare
Element Material	17-4PH Stainless Steel		

PART NUMBER		
Rated Capacity	Part No.	Shipping Weight (kg) Approx.
10kg.....	247ASLH-10kg.....	0.09
25kg.....	247ASLH-25kg.....	0.09
30kg.....	247ASLH-30kg.....	0.09
50kg.....	247ASLH-50kg.....	0.09
100kg.....	247ASLH-100kg.....	0.09
250kg.....	247ASLH-250kg.....	0.11
500kg.....	247ASLH-500kg.....	0.11
1t.....	247ASLH-1t.....	0.19
2t.....	247ASLH-2t.....	0.19

INTERCHANGEABLE PRODUCTS	
ANYLOAD Part No.	FUTEK Model
247ASLH-1t.....	LLB450
247ASLH-2t.....	LLB450

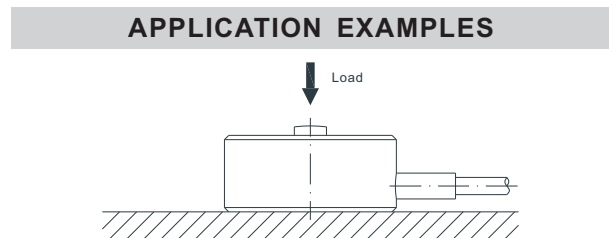

LOAD BUTTONS