

WL-RFTM-17

Wireless Transmission Module



Features:

- 3xAA alkaline batteries works up to 100 hours on 20°C at the lowest power set up
- PVC water-proof, IP67
- Wireless Frequency: 433Mhz or 915Mhz
- Transmission Range: Up to 75m without obstruction
- One 7-pin connect included, which can connect the cable with external diameter of 5 - 8mm
- Matched with 805HP-WL wireless indicator (order separately)

Indicator to be ordered separately.
Refer to Page 153 for details.

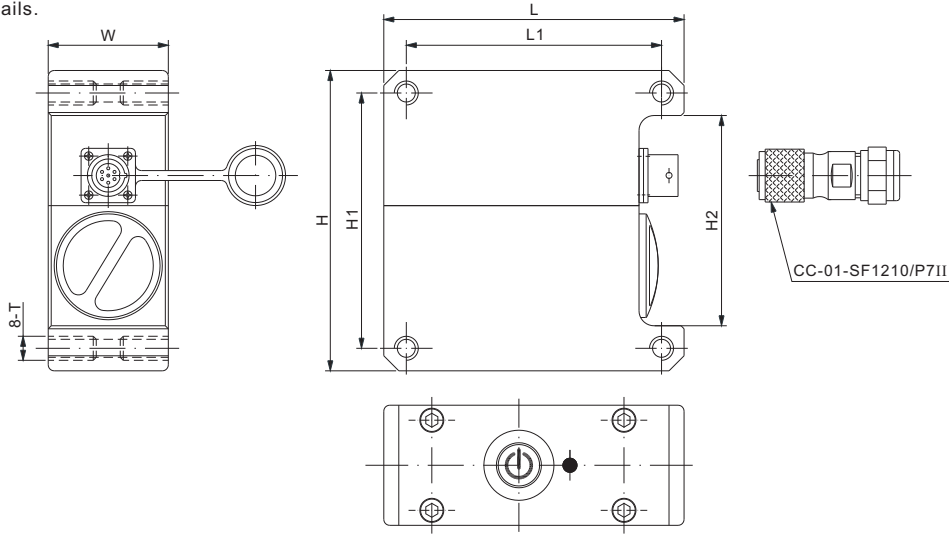

DIMENSIONS

	H	H1	H2	L	L1	W	T
mm	100.0	85.0	70.0	100.0	85.0	40.0	M8 Depth15
inches	3.94	3.35	2.76	3.94	3.35	1.57	M8 Depth0.59

SPECIFICATIONS

Load Cell Type		Any kind of mV/V output load cell, force transducer, sensor or scale
Net Weight	kg/lb	0.7 / 1.5
Transmission Range	m	Up to 75 without obstruction
Operation Time	hours	Up to 100 on 20°C at the lowest power set up
Working Temperature	°C/°F	-20 to 70 / -4 to 158
Wireless Frequency	Mhz	433; 915
Power Supply		3xAA Alkaline batteries (included)
IP Rating		IP67
Enclosure Material		PVC

PART NUMBER

Part No.	Frequency	Net Weight (kg)
WL01-RFTM-17.....	433Mhz.....	0.7
WL02-RFTM-17.....	915Mhz.....	0.7

CONNECTION DIAGRAM

