

WL-RFTM-17

PVC Water-Proof Casting; External Wireless Transmission Module



Features:

- Fully charged battery works for 100 hours.
- Material: PVC water-proof casting
- Wireless Frequency: 433Mhz or 915Mhz
- Transmission Range: Up to 75m
- One 7-pin connect included, which can connect the cable with external diameter of 5 - 8mm
- Matched with 805HP-WL wireless indicator (order separately)

Indicator to be ordered separately.
Refer to Page 153 for details.

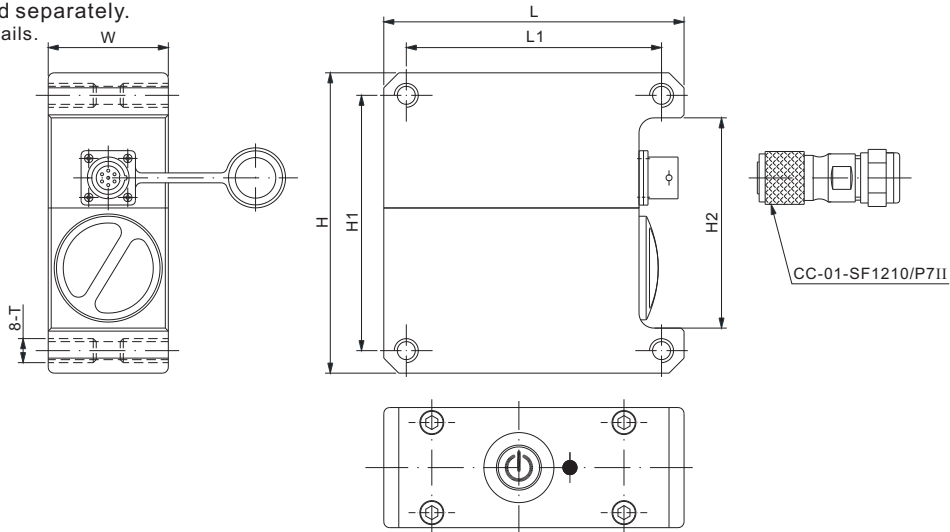

DIMENSIONS

	H	H1	H2	L	L1	W	T
mm	100.0	85.0	70.0	100.0	85.0	40.0	M8 Depth15
inches	3.94	3.35	2.76	3.94	3.35	1.57	M8 Depth0.59

SPECIFICATIONS

Load Cell Type		All strain gauge type
Net Weight	kg/lb	0.7 / 1.5
Transmission Range	m	Up to 75
Operation Time	hours	Up to 100
Working Temperature	°C/°F	-10 to 50 / 14 to 122
Working Humidity	RH	<85%
Wireless Frequency	MHz	433; 915
Power Supply		3xAA Alkaline batteries (included)
IP Rating		IP67
Enclosure Material		PVC casting

PART NUMBER

Part No.	Frequency	Net Weight (kg)
WL01-RFTM-17.....	433Mhz.....	0.7
WL02-RFTM-17.....	915Mhz.....	0.7

CONNECTION DIAGRAM

