

# ANYLOAD<sup>®</sup>

## 808HA Plus

Remote Large Display

Installation and Operations Manual (v1705)



**Anyload Transducer Co. Ltd**

Website: [www.anyload.com](http://www.anyload.com)

Email: [info@anyload.com](mailto:info@anyload.com)

## 1. Introduction

Thank you for choosing Anyload 808HA Plus Remote Large Digital Display. The 808HA Plus remote display features ultra-bright LED display and non-glare filtered lens for use in a wide variety of applications. The 808HA Plus is available with a 7-segment, 6-digit display, comes with 4 annunciators G, N, kg & lb. The 808HA Plus is designed to work with Anyload 805TS and 805BS indicators and some available digital weighing indicators in the market by using RS-232 or RS-485 or voltaic annulus communications. The 808HA Plus is equipped with wireless capability to work with Anyload 805HP-WL Hand Held Wireless Digital Weight Indicator.

The 808HA Plus can be easily installed by being mounted to a wall or pole, or suspended with a pair of hooks. This manual provides installation and configuration instructions for the display.

## 2. Features

- ✓ High-intensity 4-inch red digits and annunciators (discrete LED, double row)
- ✓ Durable weather-tight enclosure
- ✓ Non-glare contrast filtered lens
- ✓ Aluminum enclosure, IP65
- ✓ RS-232 or RS-485 or voltaic annulus communications interface
- ✓ 100/240 VAC 50/60Hz power supply
- ✓ Can be connected with various weighing indicators in a wide variety of applications
- ✓ Auto-Learn for instant recognition of data stream format
- ✓ Easy installation and easy configuration
- ✓ Wired and Wireless communications ( wireless is applicable only for Anyload 805HP-WL indicator )

### 3. Specifications

Display	6 digits, 7 segment discrete ultra bright red LED; Annunciators for G(Gross), N(Net), kg and lb.
Input interface	RS232/RS485/voltaic annulus
Input Data Format	Baud Rate: 9600
Mode of data transmission	Continuous
Power Supply	100/240 VAC 50/60Hz
Power Consumption	Approximately 20watt
Enclosure Material/Rating	Aluminum, IP65
Dimensions	688mm x 194mm x 94mm
Weight	4.5 kg (10 lb)
Operating Temperature Range	-10°C to 50°C

### 4. Dimensions

(in mm; 1mm = 0.03937 inches)

#### Enclosure Dimensions:

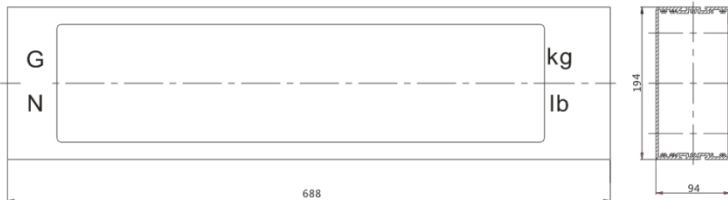

#### Bracket Dimensions:

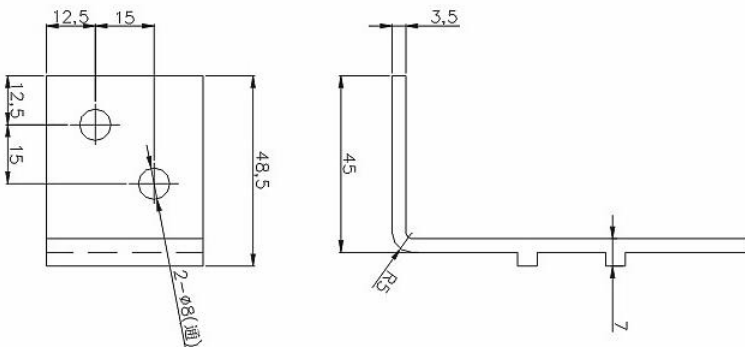

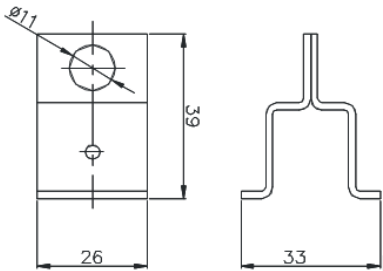
**Hanger Dimensions:****5. Installation and Wire Connection****5.1 Unpacking**

The main components of the 808HA Plus includes:

- ✓ Painted black aluminum enclosure
- ✓ AC Adapter x1
- ✓ Accessories bag: Bracket (wall mounting kit) x2, Hanger x2, screws and nuts.

After unpacking, visually check the 808HA Plus remote display for any damages. Notify your dealer immediately if found some parts and components of the item were damaged during shipment.

**5.2 Wall Mounting**

The 808HA Plus remote display can be mounted to any vertical surface or pole. Use installation screws or wall anchors to secure the brackets to a wall. The brackets fit with 8mm screw holes. Once the brackets are secured, make sure the enclosure is in the right slot and put the enclosure above the brackets. Double check the enclosure is properly installed before powering up the display.



### 5.3 Hanger Installation

The 808HA plus can also be suspended with two hooks at the same height. The distance between two hooks is adjustable.

Slide the hangers into the slot. Make sure the distances between two hangers and the sides of the enclosure are exactly the same so that the enclosure can be suspended horizontally. Use the screws and nuts provided, to tighten the hanger.



### 5.4 Wire Connection

The 808HA Plus remote display provides two cord grips located on the side of the enclosure for cabling. One for the power supply and the other for serial communication.

The 808HA Plus provides RS-232 or RS-485 or voltaic annulus communications to the weighing indicators. The communication cord indicates wiring codes for connecting to the indicator, as follows:

- ✓ the red wire: RS-485+
- ✓ the black wire: RS-485-
- ✓ the yellow wire: voltaic annulus+
- ✓ the blue wire: voltaic annulus-
- ✓ the white wire: RS-232 GND
- ✓ the green wire: RS-232 write

#### The 808HA plus and wire connections:



## 6. Configurations

Once the 808HA Plus remote display is installed, it may need some configurations. Using the Auto-Learn, it simplifies configurations by automatically detecting the communications format used by the indicators. This feature may eliminate the need for configuration.

### 6.1 Auto-Learn

The 808HA Plus remote display is equipped with a software feature called Auto-Learn. Auto-Learn examines the serial data stream sent from the weighing indicators and attempts to determine the data settings and format used by the weighing indicators.

The 808HA Plus remote display can work and can be connected with most weighing indicators in the market. List of supported weighing indicators are provided in Section 8 of this manual

### 6.2 Mode of Data Transmission

The 808HA Plus remote display has the ability to receive continuous data, display digits and annunciators. Before powering up the display, make sure the mode of data of transmission of the weighing indicators is set to **Continuous**.

### 6.3 Working Mode

When powering on the 808HA Plus remote display, it will run self-test. Display will show “:8.8.8.8.8.8”.

After the self-test, if the display is connected to the weighing indicator properly, it will receive the data stream sent from the indicator, and show current weighing data.

If the connection between the display and the indicator is incorrect, the display will take turns to show “ - - - - - ” and “:8.8.8.8.8.8:”, check the wire connection and restart the display and the indicator.

### 6.4 Anyload 805TS and 805BS indicators configurations

The 808HA Plus can be connected through RS-232 or RS-485 to Anyload 805TS and 805BS Digital Weight Indicators. Refer to Section 5.4 of this manual for the wiring connection of RS-232 and RS-485. Also, refer to Operations manual of 805TS and 805BS for configuring the RS-232 or RS-485 like the wiring terminals, baud rate ( should be 9600 ) and mode of data of transmission ( should be continuous ).

Once all required configuration settings are set, run the devices in an Auto-Learn procedure. The 808HA Plus is connected to the 805TS or 805BS properly when after the self test the large display shows the current weighing data.

**6.5 Wireless configurations with Anyload 805HP-WL Hand Held Wireless Digital Indicator** (not applicable in 808HA641 or 808HA641-01 models)

The 808HA Plus can be paired to Anyload 805HP-WL wireless indicator. Set the baud rate to 9600 baud and mode of data transmission to continuous for your 805HP-WL indicator.

Once the required configuration settings are set, run the devices in an Auto-Learn procedure. If the current weighing data is displayed in the 805HP-WL, the two devices are configured properly.

**7. Troubleshooting**

Issues	Recommended solutions
Both large display and indicator are not working after the Auto-Learn procedure	<ol style="list-style-type: none"> <li>1. Check the wiring connection if it is configured correctly</li> <li>2. Check the configuration settings if the baud rate is set to 9600 baud and the mode of data of transmission is continuous</li> </ol>
No display in the large display	<ol style="list-style-type: none"> <li>1. Check if the power supply is properly inserted and compliant to the device</li> <li>2. If the power supply is good and compliant, contact your supplier</li> </ol>

## 8. List of Supported Indicators

<b>Manufacturer</b>	<b>Model</b>	<b>Interface</b>
Anyload	805TS series	RS-232/RS-485
Anyload	805BS series	RS-232/RS-485
Anyload	805HP-WL	Wireless
AND	AD-4321	RS-232/RS-485
AND	AD-4323	RS-232/RS-485
DINI ARGEO	DGT1/DGT4/DGTQ/DGTP	RS-232/RS-485
TOLEDO & Fairbanks	R2500	RS-232/RS-485
Rice Lake	UMC 600	RS-232/RS-485
GSE	GSE 50 series	RS-232/RS-485
Avery Weigh-Tronix	WI-125	RS-232/RS-485
Avery Weigh-Tronix	WI-127	RS-232/RS-485
Bilanciali	Bilanciali D800 Cb	RS-232/RS-485
HBM	WE2107 EOP 6	RS-232/RS-485