

Alloy Steel; Wireless Tension Link; Patent Design

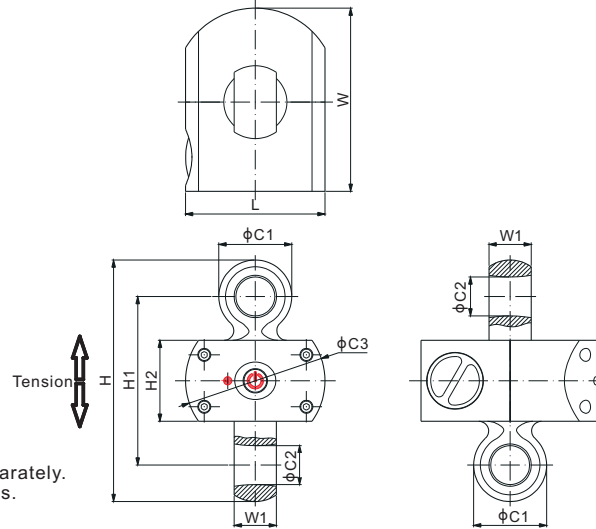

TENSLINK™



* Indicator to be ordered separately. Refer to Page 185 for details.

CE RoHS

TENSION LINKS

| RATED CAPACITY | DIMENSIONS | | | | | | | | | SUGGESTED SHACKLE | |
|---|------------|------|-------|-------|-------|------|-------|-------|-------|----------------------------------|--|
| | C1 | C2 | C3 | H | H1 | H2 | L | W | W1 | | |
| t/mm | | | | | | | | | | | |
| 0.5; 1; 2 | 33.0 | 18.0 | 80.0 | 110.0 | 74.0 | 38.0 | 80.0 | 110.0 | 18.0 | Crosby G-2130-2t or SBX-2t | |
| 3 | 35.0 | 21.0 | 80.0 | 129.0 | 88.0 | 38.0 | 80.0 | 110.0 | 25.0 | Crosby G-2130-3.25t or SBX-3.25t | |
| 5 | 50.0 | 27.0 | 86.0 | 164.6 | 110.6 | 50.0 | 86.0 | 113.0 | 33.0 | Crosby G-2130-6.5t or SBX-6.5t | |
| 10 | 63.0 | 37.0 | 86.0 | 205.0 | 135.0 | 50.0 | 86.0 | 125.0 | 41.0 | Crosby G-2130-12t or SBX-12t | |
| 20 | 90.0 | 53.0 | 100.0 | 249.0 | 153.0 | 53.0 | 100.0 | 140.0 | 66.0 | Crosby G-2130-25t or SBX-25t | |
| 30 | 87.0 | 44.0 | 100.0 | 248.0 | 150.0 | 50.0 | 100.0 | 152.0 | 58.0 | Crosby G-2140-30t or TBX-30t | |
| 50 | 115.0 | 62.0 | 150.0 | 321.0 | 206.0 | 74.0 | 150.0 | 170.0 | 79.0 | Crosby G-2140-55t or TBX-50t | |
| 100 | 170.0 | 88.0 | 180.0 | 442.0 | 260.0 | 65.0 | 180.0 | 190.0 | 122.0 | Crosby G-2140-120t or TBX-110t | |
| Kilb/inches (conversion of above dimensions) | | | | | | | | | | | |
| 1; 2; 4 | 1.30 | 0.71 | 3.15 | 4.33 | 2.91 | 1.50 | 3.15 | 4.33 | 0.71 | Crosby G-2130-2t or SBX-2t | |
| 5 | 1.38 | 0.83 | 3.15 | 5.08 | 3.46 | 1.50 | 3.15 | 4.33 | 0.98 | Crosby G-2130-3.25t or SBX-3.25t | |
| 10 | 1.97 | 1.06 | 3.39 | 6.48 | 4.35 | 1.97 | 3.39 | 4.45 | 1.30 | Crosby G-2130-6.5t or SBX-6.5t | |
| 20 | 2.48 | 1.46 | 3.39 | 8.07 | 5.31 | 1.97 | 3.39 | 4.92 | 1.61 | Crosby G-2130-12t or SBX-12t | |
| 40 | 3.54 | 2.09 | 3.94 | 9.80 | 6.02 | 2.09 | 3.94 | 5.51 | 2.60 | Crosby G-2130-25t or SBX-25t | |
| 60 | 3.43 | 1.73 | 3.94 | 9.76 | 5.91 | 1.97 | 3.94 | 5.98 | 2.28 | Crosby G-2140-30t or TBX-30t | |
| 100 | 4.53 | 2.44 | 5.91 | 13.03 | 8.11 | 2.91 | 5.91 | 6.69 | 3.11 | Crosby G-2140-55t or TBX-50t | |
| 200 | 6.69 | 3.46 | 7.09 | 17.40 | 10.24 | 2.56 | 7.09 | 7.48 | 4.80 | Crosby G-2140-120t or TBX-110t | |

| SPECIFICATIONS | | | | | |
|----------------|------------------|-----------------------------|----------------------------------|---|-------------------------------|
| Division | 500kg | 0.1kg | Combined Error | 0.03% | |
| | 1t | 0.2kg | Max. Safety Load | 200% of full scale | |
| | 2t | 0.5kg | Ultimate Load | 500% of full scale | |
| | 3t, 5t | 1kg | Transmission Range | Up to 30m at lowest power setting. | |
| | 10t | 2kg | | Up to 75m at highest power setting, unobstructed | |
| | 20t | 5kg | Rechargeable Battery Type | 3 × AA Alkaline batteries | |
| | 30t, 50t | 10kg | Operation Time | Up to 100 hours at 20°C and at the lowest power setting | |
| | 100t | 20kg | Operating Humidity | <85% RH under 20°C [68°F] | |
| | IP Rating | IP67 | | Operating Temperature | -10°C to 50°C / 14°F to 122°F |
| | Enclosure | Alloy Steel, Powder Coating | | | |

| PART NUMBER | | | |
|----------------|--------------|--------------------------|--------------------------|
| Rated Capacity | Frequency | Part No. | Self Weight Approx. (kg) |
| 500kg..... | 433 MHz..... | 110RH-ST-500kg-WL01..... | 0.6 |
| | 915 MHz..... | 110RH-ST-500kg-WL02..... | 0.6 |
| 1t | 433 MHz..... | 110RH-ST-1t-WL01..... | 0.6 |
| | 915 MHz..... | 110RH-ST-1t-WL02..... | 0.6 |
| 2t | 433 MHz..... | 110RH-ST-2t-WL01..... | 0.6 |
| | 915 MHz..... | 110RH-ST-2t-WL02..... | 0.6 |
| 3t | 433 MHz..... | 110RH-ST-3t-WL01..... | 1.0 |
| | 915 MHz..... | 110RH-ST-3t-WL02..... | 1.0 |
| 5t | 433 MHz..... | 110RH-ST-5t-WL01..... | 1.4 |
| | 915 MHz..... | 110RH-ST-5t-WL02..... | 1.4 |

| PART NUMBER | | | |
|----------------|--------------|------------------------|--------------------------|
| Rated Capacity | Frequency | Part No. | Self Weight Approx. (kg) |
| 10t | 433 MHz..... | 110RH-ST-10t-WL01..... | 2.3 |
| | 915 MHz..... | 110RH-ST-10t-WL02..... | 2.3 |
| 20t | 433 MHz..... | 110RH-ST-20t-WL01..... | 4.7 |
| | 915 MHz..... | 110RH-ST-20t-WL02..... | 4.7 |
| 30t | 433 MHz..... | 110RH-30t-WL01..... | 5.5 |
| | 915 MHz..... | 110RH-30t-WL02..... | 5.5 |
| 50t | 433 MHz..... | 110RH-50t-WL01..... | 16.0 |
| | 915 MHz..... | 110RH-50t-WL02..... | 16.0 |
| 100t | 433 MHz..... | 110RH-100t-WL01..... | 35.0 |
| | 915 MHz..... | 110RH-100t-WL02..... | 35.0 |