

563SH

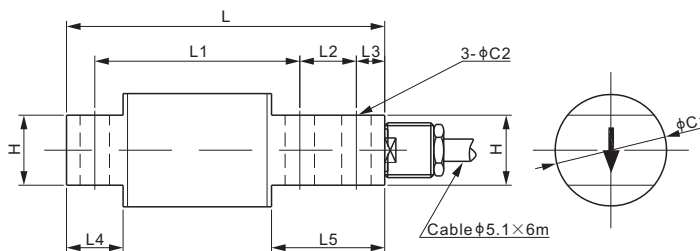

Alloy Steel

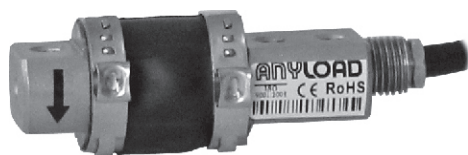

SINGLE ENDED BEAMS

CE RoHS

DIMENSIONS

RATED CAPACITY	C1	C2	H	L	L1	L2	L3	L4	L5
lb/inches									
25-500	1.30	0.26	0.62	2.81	1.81	0.50	0.25	0.50	1.00
kg/mm (conversion of above dimensions)									
11.34-226.8	33.0	6.6	15.7	71.4	46.0	12.7	6.35	12.7	25.4

SPECIFICATIONS

Full Scale Output	3.0 ± 10% mV/V	Recommended Excitation	10V (15V Maximum)
Zero Balance	± 0.02 mV/V	Insulation Resistance	>2 [50V DC] GΩ
Combine error	0.03% of full scale	Compensated Temperature Range	-10°C to 50°C / 14°F to 122°F
Non-linearity	< ± 0.030%	Safe Overload	150% of full scale
Repeatability	< ± 0.020%	Breaking Overload	300% of full scale
Hysteresis Error	< ± 0.020%	Seal Type / IP Rating	Environmentally Sealed / IP65
Creep in 30 min.	< ± 0.030%	Cable Color Code	Exc+ Red Exc- Black
Input Resistance	400 Ω ± 20		Sig+ Green Sig- White
Output Resistance	350 Ω ± 3		Shield Bare
Element Material	Alloy Steel, Nickel Plated		

PART NUMBER

Rated Capacity	Part No.	Shipping Weight (kg) Approx.
25lb.....	563SH-25lb.....	0.26
50lb.....	563SH-50lb.....	0.26
100lb.....	563SH-100lb.....	0.36
150lb.....	563SH-150lb.....	0.36
200lb.....	563SH-200lb.....	0.36
250lb.....	563SH-250lb.....	0.36
300lb.....	563SH-300lb.....	0.36
500lb.....	563SH-500lb.....	0.36

INTERCHANGEABLE PRODUCTS

Manufacturer	Model
Artech.....	50210
Rice Lake.....	RL50210
Vishay Revere Transducers.....	5503
Vishay Sensortronics.....	60040