

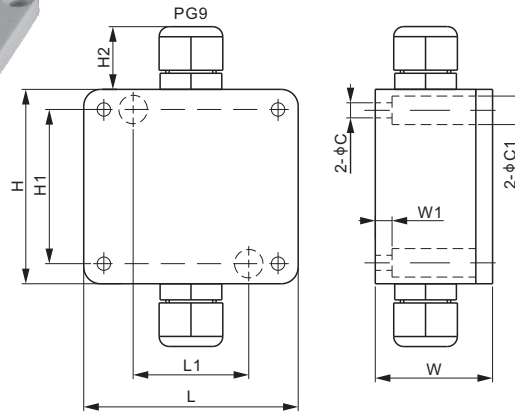

### Features:

- Can drive up to 2 x350Ω load cells or 4x700Ω load cells
- Can be connected directly to 1 load cell or connected to several load cells through a junction box



### DIMENSIONS

	C	C1	H	H1	H2	L	L1	W	W1
mm	4.5	8.5	58	46	18	64	34.5	35	5
inches	0.2	0.3	2.3	1.8	0.7	2.5	1.4	1.4	0.2

### SPECIFICATIONS

Load Cell Type		All strain gage type
Weight (G), approx.	kg/lb	0.15 / 0.33
Accuracy	%FS	0.2
Power Supply	V DC	24 ± 10%
Input Range	mV	0 - 30
Max. Power Voltage	DC	30V, 2.5A
Output Signal	V	0 - 10
	mA	4 - 20
Max. Output Signal	V	12
Protection Class		IP66
Enclosure Material		Aluminum casting

### CONNECTION DIAGRAM

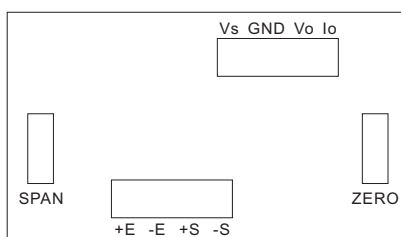

### PART NUMBER

Part No.	Shipping Weight (kg) Approx.
A1A.....	0.15