

SPACERSS

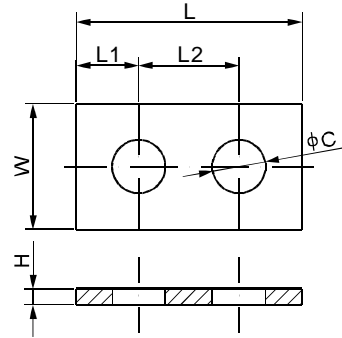

Load Cell Spacer, Stainless Steel

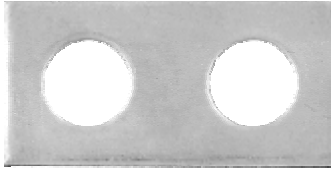

DIMENSIONS

PART NUMBER	LOAD CELL CAPACITY *	C	H	L	L1	L2	W
kg/mm							
SPACERSS-1/2	100-2,000	13.5	4	57.20	15.8	25.4	31.8
SPACERSS-3/4	2,500-5,000	19.8	4	76.20	19.1	38.1	38.1
SPACERSS-1	10,000	26.2	5	101.6	25.4	50.8	50.8
lb/inch							
SPACERSS-1/2	100-SE5,000	0.53	0.16	2.25	0.62	1.00	1.25
SPACERSS-3/4	5,000; 10,000	0.78	0.16	3.00	0.75	1.50	1.50
SPACERSS-1	15,000; 20,000	1.03	0.20	4.00	1.00	2.00	2.00

* Refer to 563 series.