

Capacity: 3-75kg

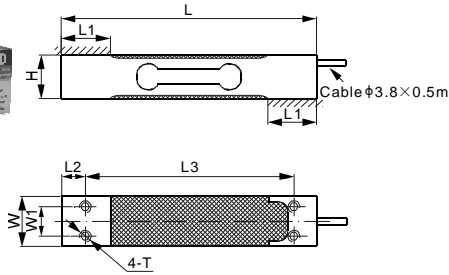

Capacity: 100kg; 150kg

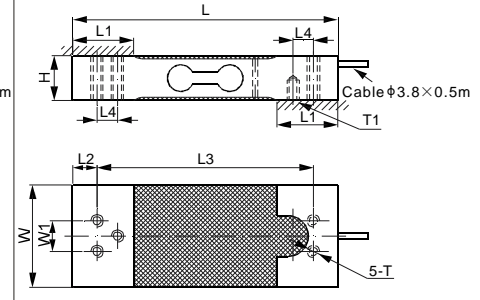

DIMENSIONS

RATED CAPACITY	H	L	L1	L2	L3	L4	W	W1	T	T1
kg/mm										
3 - 30	22.0	130.0	25.0	12.0	106.0	-	25.4	15.0	M6	-
35; 40	22.0	130.0	25.0	12.0	106.0	-	30.0	15.0	M6	-
45	22.0	130.0	30.0	12.0	106.0	-	30.0	15.0	M6	-
50; 60; 75	22.0	130.0	30.0	12.0	106.0	-	38.5	15.0	M6	-
100; 150	22.0	130.0	30.0	12.0	106.0	10.0	50.0	15.0	M6	M6 Depth10
lb/inches (conversion of above dimensions)										
6.61 - 66.14	0.87	5.12	0.98	0.47	4.17	-	1.00	0.59	M6	-
77.16 - 88.18	0.87	5.12	0.98	0.47	4.17	-	1.18	0.59	M6	-
99.21	0.87	5.12	1.18	0.47	4.17	-	1.18	0.59	M6	-
110.23; 132.28; 165.35	0.87	5.12	1.18	0.47	4.17	-	1.52	0.59	M6	-
220.46; 330.69	0.87	5.12	1.18	0.47	4.17	0.39	1.97	0.59	M6	M6 Depth0.39

SPECIFICATIONS

Type	YZ108	Recommended Excitation	10V (15V Maximum)
Full Scale Output	2.0 ± 10% mV/V	Reference Max. Platform Size	400×400 mm
Zero Balance	± 0.02 mV/V	Insulation Resistance	>2 [50V DC] GΩ
Non-linearity	< ± 0.017%	Nominal Temperature Range	-10°C to 40°C / 14°F to 104°F
Repeatability	< ± 0.017%	Safe Overload	150% of full scale
Hysteresis Error	< ± 0.017%	Breaking Overload	300% of full scale
Creep in 30 min.	< ± 0.023%	Seal Type / IP Rating	Environmentally Sealed / IP66
Input Resistance	415Ω ± 15	Cable Color Code	Exc+ Red Exc- Black Sig+ Green Sig- White Shield Bare
Output Resistance	350Ω ± 3		
Element Material	Aluminum		

PART NUMBER

Rated Capacity	Part No.	Shipping Weight (kg) Approx.
3kg.....	108BA-3kg.....	0.2
6kg.....	108BA-6kg.....	0.2
7kg.....	108BA-7kg.....	0.2
10kg.....	108BA-10kg.....	0.2
20kg.....	108BA-20kg.....	0.2
30kg.....	108BA-30kg.....	0.2
35kg.....	108BA-35kg.....	0.2
40kg.....	108BA-40kg.....	0.2
45kg.....	108BA-45kg.....	0.2
50kg.....	108BA-50kg.....	0.26
60kg.....	108BA-60kg.....	0.26
75kg.....	108BA-75kg.....	0.26
100kg.....	108BA-100kg.....	0.36
150kg.....	108BA-150kg.....	0.36

INTERCHANGEABLE PRODUCTS

Manufacturer	Model
Mettler-Toledo	MT1022
HBM.....	PW6C3
HBM.....	PW6K
Rice Lake.....	RL1521A
Vishay Celtron.....	LPS ME 6-35kg
Vishay Tedea-Huntleigh.....	1022

10kg-150kg: OIML C3, Y=4 300