

# 108MA; 108MAUN

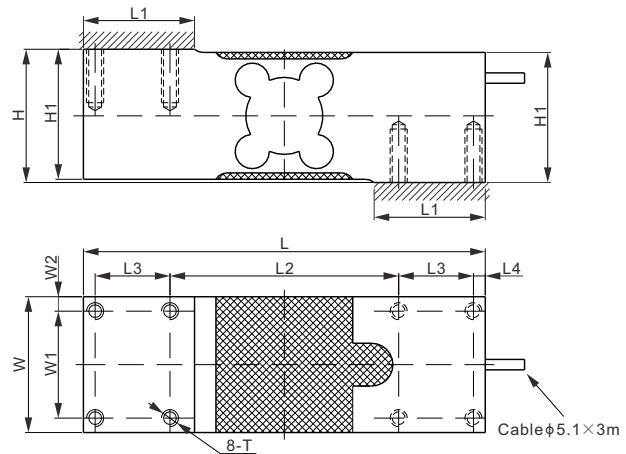

## Aluminum



### DIMENSIONS

RATED CAPACITY	H	H1	L	L1	L2	L3	L4	W	W1	W2	T
<b>108MAUN, 108MAUN-A1:</b>											
<b>kg/mm</b>											
50-1,000	62.3	60.8	188.0	52.0	107.0	35.0	5.5	63.5	50.0	6.8	5/16-18 UNC-2B Depth20
<b>lb/inches</b> (conversion of above dimensions)											
110.23-2,204.62	2.45	2.39	7.40	2.05	4.21	1.38	0.22	2.50	1.97	0.27	5/16-18 UNC-2B Depth0.8
<b>108MA, 108MA-A1:</b>											
<b>kg/mm</b>											
50-1000	62.3	60.8	188.0	52.0	107.0	35.0	5.5	63.5	50.0	6.8	M8 Depth20
<b>lb/inches</b> (conversion of above dimensions)											
110.23-2,204.62	2.45	2.39	7.40	2.05	4.21	1.38	0.22	2.50	1.97	0.27	M8 Depth0.8

### SPECIFICATIONS

Maximum Capacity (E <sub>max</sub> )	kg	50 / 75 / 100 / 150 / 200 / 250 / 300 / 500 / 635 / 660 / 1000			
Model		108MA/108MAUN		108MA-A1/108MAUN-A1	
Accuracy class according to NTEP Class III S		1:3000		1:4000	
Maximum number or verification interval (n <sub>max</sub> )		3000		4000	
Y		12300			
Temperature effect on zero balance	%*Cn/K	± 0.00114			
Temperature effect on sensitivity	%*Cn/K	± 0.0012		± 0.000875	
Non-linearity	%*Cn	± 0.017		± 0.010	
Hysteresis Error	%*Cn	± 0.017		± 0.012	
Creep error (30min)/DR	%*Cn	± 0.017		± 0.012	
Full Scale Output (C <sub>n</sub> )	mV/V	2 ± 10%			
Zero Balance	mV/V	± 0.02			
Recommended voltage	V	10 (15 Maximum)			
Input Resistance	Ω	415 ± 15			
Output Resistance	Ω	350 ± 3			
Insulation resistance [50V DC]	GΩ	>2			
Safe overload [Elim]	%*E <sub>max</sub>	150			
Breaking overload	%*E <sub>max</sub>	300			
Safe side load	%*E <sub>max</sub>	100			
Nominal temperature range	°C / °F	-10 to 40 / 14 to 104			
Element Material		Aluminum, Clear Anodized			
Seal type / IP rating		Environmentally Sealed / IP66			
Cable color code		Exc+ Red	Exc- Black	Sig+ Green	Sig- White

SINGLE POINTS

### PART NUMBER\*

#### Metric thread, 1:3000 accuracy

Rated Capacity	Part No.	Weight (kg) Approx.
50kg	108MA-50kg	1.9
75kg	108MA-75kg	1.9
100kg	108MA-100kg	1.9
150kg	108MA-150kg	1.9
200kg	108MA-200kg	1.9
250kg	108MA-250kg	1.9
300kg	108MA-300kg	1.9
500kg	108MA-500kg	1.9
635kg	108MA-635kg	1.9
660kg	108MA-660kg	1.9
1000kg	108MA-1000kg	1.9

#### Metric thread, 1:4000 accuracy

Rated Capacity	Part No.	Weight (kg) Approx.
50kg	108MA-50kg-A1	1.9
75kg	108MA-75kg-A1	1.9
100kg	108MA-100kg-A1	1.9
150kg	108MA-150kg-A1	1.9
200kg	108MA-200kg-A1	1.9
250kg	108MA-250kg-A1	1.9
300kg	108MA-300kg-A1	1.9
500kg	108MA-500kg-A1	1.9
635kg	108MA-635kg-A1	1.9
660kg	108MA-660kg-A1	1.9
1000kg	108MA-1000kg-A1	1.9

\* ATEX, FM, IECEx approved versions carry the "-Ex" suffix.

### INTERCHANGEABLE REFERENCE

Manufacturer	Model
<b>108MA</b>	
Mettler-Toledo	MT1260
<b>108MAUN</b>	
Coti Global	CG-50-1
HBM	PW16
Rice Lake	RL26018A
Rice Lake	RLPWW16
Rice Lake	RL1260
Vishay Tedeo-Huntleigh	1260



50kg-500kg: NTEP 1:5 000 Class III, Single Cell;  
635kg-660kg: NTEP 1:4 000 Class III, Single Cell



50kg-500kg: OIML-CS C6, Y=29 000;  
635kg-660kg: OIML-CS C4, Y=4 000

For further definition of P/N's & specifications per NTEP/OIML classes, please contact us.

### PART NUMBER\*

#### Imperial thread, 1:3000 accuracy

Rated Capacity	Part No.	Weight (kg) Approx.
50kg	108MAUN-50kg	1.9
75kg	108MAUN-75kg	1.9
100kg	108MAUN-100kg	1.9
150kg	108MAUN-150kg	1.9
200kg	108MAUN-200kg	1.9
250kg	108MAUN-250kg	1.9
300kg	108MAUN-300kg	1.9
500kg	108MAUN-500kg	1.9
635kg	108MAUN-635kg	1.9
660kg	108MAUN-660kg	1.9
1000kg	108MAUN-1000kg	1.9

#### Imperial thread, 1:4000 accuracy

Rated Capacity	Part No.	Weight (kg) Approx.
50kg	108MAUN-50kg-A1	1.9
75kg	108MAUN-75kg-A1	1.9
100kg	108MAUN-100kg-A1	1.9
150kg	108MAUN-150kg-A1	1.9
200kg	108MAUN-200kg-A1	1.9
250kg	108MAUN-250kg-A1	1.9
300kg	108MAUN-300kg-A1	1.9
500kg	108MAUN-500kg-A1	1.9
635kg	108MAUN-635kg-A1	1.9
660kg	108MAUN-660kg-A1	1.9
1000kg	108MAUN-1000kg-A1	1.9

### AVAILABLE OPTION

- stainless steel version of 108MAUN: 651KS55UN (page 75)

# Product Datasheet Disclaimer

## **Information Changes:**

All product specifications, statements, information, and data (collectively, the “Information”) in this catalog or made available elsewhere by ANYLOAD are subject to change. Customers must verify the applicability of the Information at the time of order placement.

## **Accuracy and Reliability:**

While all Information is believed to be accurate and reliable, it is presented without guarantee, warranty, or responsibility of any kind, expressed or implied.

## **Laboratory Conditions:**

Data listed in the datasheet is produced within controlled laboratory settings and may not be reproducible without exact replication of all metrological conditions. Users must validate that a product with the described properties is suitable for their applications.

## **Interchangeability:**

Statements of interchangeability with other manufacturers are based on ANYLOAD’s knowledge at the time of publication and are not intended to constitute any warranty concerning the substitutability of an ANYLOAD product with one made by another Manufacturer.

## **Warranty Voidance:**

Any use of the product outside of specifications or any storage or installation inconsistent with product guidance voids any warranty.

## **Intended Use:**

The information is intended for use only by customers who have the requisite experience and capability to determine the correct products for their application. ANYLOAD provides technical advice without obligation or liability for the advice given or results obtained.

## **Component Failures:**

Although ANYLOAD designs and manufactures its products to stringent quality and safety standards, isolated component failures may still occur. Applications requiring high reliability or safety should employ suitable designs or safeguards to ensure that component failure does not result in personal injury or property damage.

## **High-Risk Applications:**

Unless specifically agreed to in writing, ANYLOAD has not tested or certified its products, services, or deliverables for use in high-risk applications (e.g., medical life support, nuclear facilities, weapon systems). ANYLOAD makes no assurances that the products are suitable for high-risk uses. Under no circumstances does ANYLOAD warrant or guarantee suitability for any customer design or manufacturing process.

Contact authorized ANYLOAD personnel for special terms and conditions regarding products designed for specific safety requirements.

## **Safety Measures:**

All product-related warnings, cautions, and notes must be observed. Customers should not assume that all safety measures are indicated or that other measures may not be required.

---

## **California Proposition 65:**

**⚠ WARNING:** Some products manufactured or distributed by ANYLOAD may contain trace amounts of chemicals known to the State of California to cause cancer, birth defects, or other reproductive harm. These substances are present in minimal quantities and are typically encapsulated within our products. This warning is provided to enable you to make informed decisions as a consumer.