

Stainless Steel

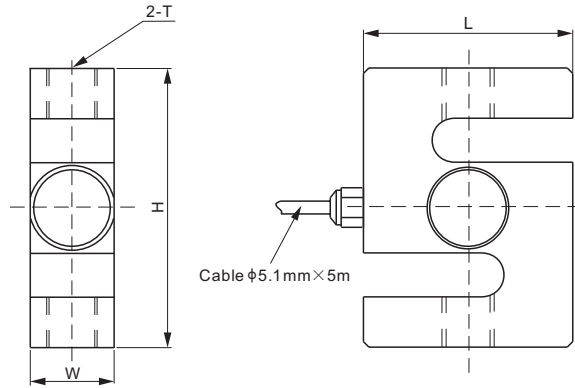

DIMENSIONS

RATED CAPACITY	H	L	W	T
lb/inches				
500-3,000	3.00	2.00	1.11	1/2-20 UNF-2B
5,000	4.00	3.00	1.11	3/4-16 UNF-2B
10,000	4.00	3.00	1.25	3/4-16 UNF-2B
15,000	5.50	4.00	1.25	1-14 UNS-2B
20,000	7.00	5.00	2.00	1 1/4-12 UNF-2B
kg/mm				
300-1,000	76.2	50.8	28.2	M12X1.75
2,000; 3,000	101.6	76.2	28.2	M16X2.00
5,000	101.6	76.2	31.8	M24X2.00
10,000	177.8	125.0	50.8	M30X2.00

SPECIFICATIONS

Full Scale Output	2.0 mV/V \pm 1%	Recommended Excitation	10V (15V Maximum)
Zero Balance	\pm 0.02 mV/V	Insulation Resistance	>2 [50V DC] G Ω
Non-linearity	$< \pm$ 0.023%	Compensated Temperature Range	-10°C to 50°C / 14°F to 122°F
Repeatability	$< \pm$ 0.030%	Safe Overload	150% of full scale
Hysteresis Error	$< \pm$ 0.030%	Breaking Overload	300% of full scale
Creep in 30 min.	$< \pm$ 0.030%	Seal Type / IP Rating	Welded Seal / IP68
Input Resistance	400 Ω \pm 20	Cable Color Code	Exc+ Red Exc- Black Sig+ Green Sig- White Shield Bare
Output Resistance	350 Ω \pm 3		
Element Material	17-4PH Stainless Steel		

PART NUMBER*

Rated Capacity	Deflection (Emax)	Part No.	Weight Approx.
300kg	0.16-0.16mm	101BS-300kg	0.8kg
500kg	0.11-0.21mm	101BS-500kg	0.8kg
1t	0.23-0.33mm	101BS-1t	0.8kg
2t	0.20-0.30mm	101BS-2t	1.5kg
3t	0.30-0.40mm	101BS-3t	1.5kg
5t	0.35-0.45mm	101BS-5t	1.7kg
10t	-	101BS-10t	7.0kg
500lb	0.002-0.006in	101BS-500lb	1.8lb
1Klb	0.004-0.008in	101BS-1Klb	1.8lb
1.5Klb	0.006-0.010in	101BS-1.5Klb	1.8lb
2Klb	0.008-0.012in	101BS-2Klb	1.8lb
2.5Klb	0.010-0.014in	101BS-2.5Klb	1.8lb
3Klb	0.012-0.016in	101BS-3Klb	1.8lb
5Klb	0.009-0.013in	101BS-5Klb	3.3lb
10Klb	0.015-0.019in	101BS-10Klb	3.8lb
15Klb	-	101BS-15Klb	6.4lb
20Klb	0.014-0.018in	101BS-20Klb	15.4lb

* ATEX, FM, IECEx approved versions carry the "-Ex" suffix.

INTERCHANGEABLE REFERENCE

Brand	Model
Coti Global	CGSB-SSW
FLINTEC	ULB
HBM	RSC*
Rice Lake	RL20001HE
Vishay Celtron	STC HSS
Vishay Sensortronics	60063
Vishay Tedea-Huntleigh	616*
Vishay Tedea-Huntleigh	620

* Glue Sealed.



100lb-500lb: up to NTEP 1:4 500 Class III, Single Cell;
1Klb-20Klb: up to NTEP 1:5 500 Class III, Single Cell
200kg-1.5t: up to OIML MAA C3, Y=17 000;
2t-10t: up to OIML MAA C4.5, Y=14 000

For further available P/N's & specifications per NTEP/OIML classes, please contact us.

Product Datasheet Disclaimer

Information Changes:

All product specifications, statements, information, and data (collectively, the “Information”) in this catalog or made available elsewhere by ANYLOAD are subject to change. Customers must verify the applicability of the Information at the time of order placement.

Accuracy and Reliability:

While all Information is believed to be accurate and reliable, it is presented without guarantee, warranty, or responsibility of any kind, expressed or implied.

Laboratory Conditions:

Data listed in the datasheet is produced within controlled laboratory settings and may not be reproducible without exact replication of all metrological conditions. Users must validate that a product with the described properties is suitable for their applications.

Interchangeability:

Statements of interchangeability with other manufacturers are based on ANYLOAD’s knowledge at the time of publication and are not intended to constitute any warranty concerning the substitutability of an ANYLOAD product with one made by another Manufacturer.

Warranty Voidance:

Any use of the product outside of specifications or any storage or installation inconsistent with product guidance voids any warranty.

Intended Use:

The information is intended for use only by customers who have the requisite experience and capability to determine the correct products for their application. ANYLOAD provides technical advice without obligation or liability for the advice given or results obtained.

Component Failures:

Although ANYLOAD designs and manufactures its products to stringent quality and safety standards, isolated component failures may still occur. Applications requiring high reliability or safety should employ suitable designs or safeguards to ensure that component failure does not result in personal injury or property damage.

High-Risk Applications:

Unless specifically agreed to in writing, ANYLOAD has not tested or certified its products, services, or deliverables for use in high-risk applications (e.g., medical life support, nuclear facilities, weapon systems). ANYLOAD makes no assurances that the products are suitable for high-risk uses. Under no circumstances does ANYLOAD warrant or guarantee suitability for any customer design or manufacturing process.

Contact authorized ANYLOAD personnel for special terms and conditions regarding products designed for specific safety requirements.

Safety Measures:

All product-related warnings, cautions, and notes must be observed. Customers should not assume that all safety measures are indicated or that other measures may not be required.

California Proposition 65:

 **WARNING:** Some products manufactured or distributed by ANYLOAD may contain trace amounts of chemicals known to the State of California to cause cancer, birth defects, or other reproductive harm. These substances are present in minimal quantities and are typically encapsulated within our products. This warning is provided to enable you to make informed decisions as a consumer.